



Stand Catalogue

WTM 2026

RX
SOLUTIONS





RX aims to drive business and positively impact individuals, communities, and organizations.



We harness the power of in-person events, combining data intelligence and digital products to connect people, offering experiences and business opportunities through more than 400 events held across 22 countries and 42 different sectors of the economy.

RX is part of the RELX Group, a global provider of information-based analytics and decision tools for professionals and businesses.



rxglobal.com/rx-brazil



RX in Brazil

 Automotivo, transporte e logística

AUTOMEC

FENATTRAN
23º SALÃO INTERNACIONAL DO TRANSPORTE RODOVIÁRIO DE CARGA



SALÃO INTERNACIONAL DO AUTOMÓVEL DE SÃO PAULO

 Construção

EXPOLUX
FEIRA INTERNACIONAL DA INDÚSTRIA DA ILUMINAÇÃO

FEBRAVA **FEBRAVA**RIO

FEICON

FEICON
Rio 2026

 Educação e cultura



27ª BIENAL INTERNACIONAL DO LIVRO DE SÃO PAULO

 Energia

fenosucro & agrocaína



 Hospitalidade



equipotel
SINÔNIMO DE HOSPITALIDADE

 Segurança



 Outros eventos RX que acontecem no Brasil



in-cosmetics
latin america

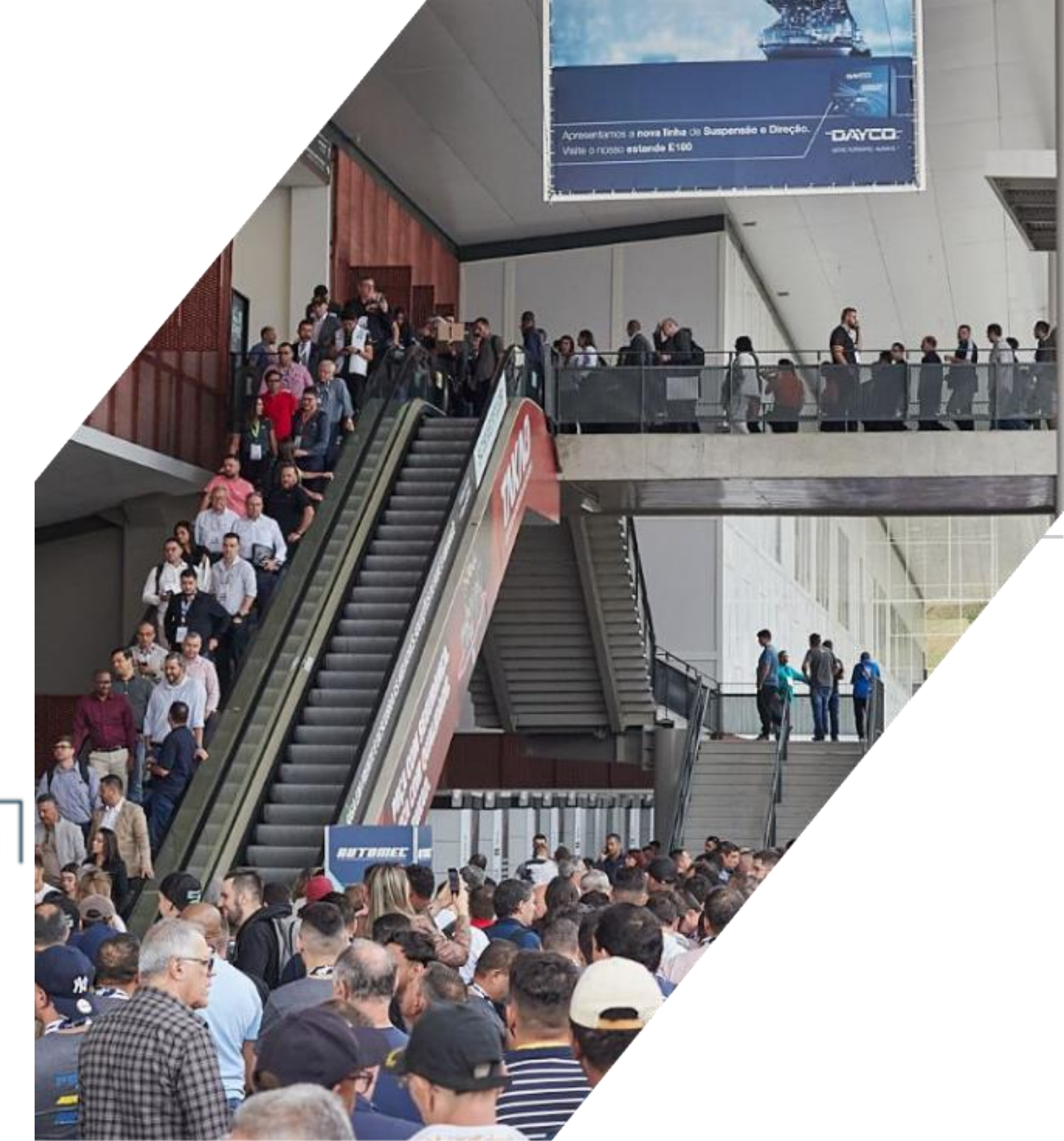

rxglobal.com/rx-brazil



RX Solutions

Standard Assembly

From 18m² up to 60m²

Silver - \$ 464,00 m²
Gold Canvas - \$ 569,00 m²
Gold Led - \$ 670,00 m²



Assembly
SILVER
LAYOUT



Assembly
SILVER
LAYOUT



Assembly
SILVER
LAYOUT



Assembly
SILVER
LAYOUT



Assembly
SILVER
LAYOUT



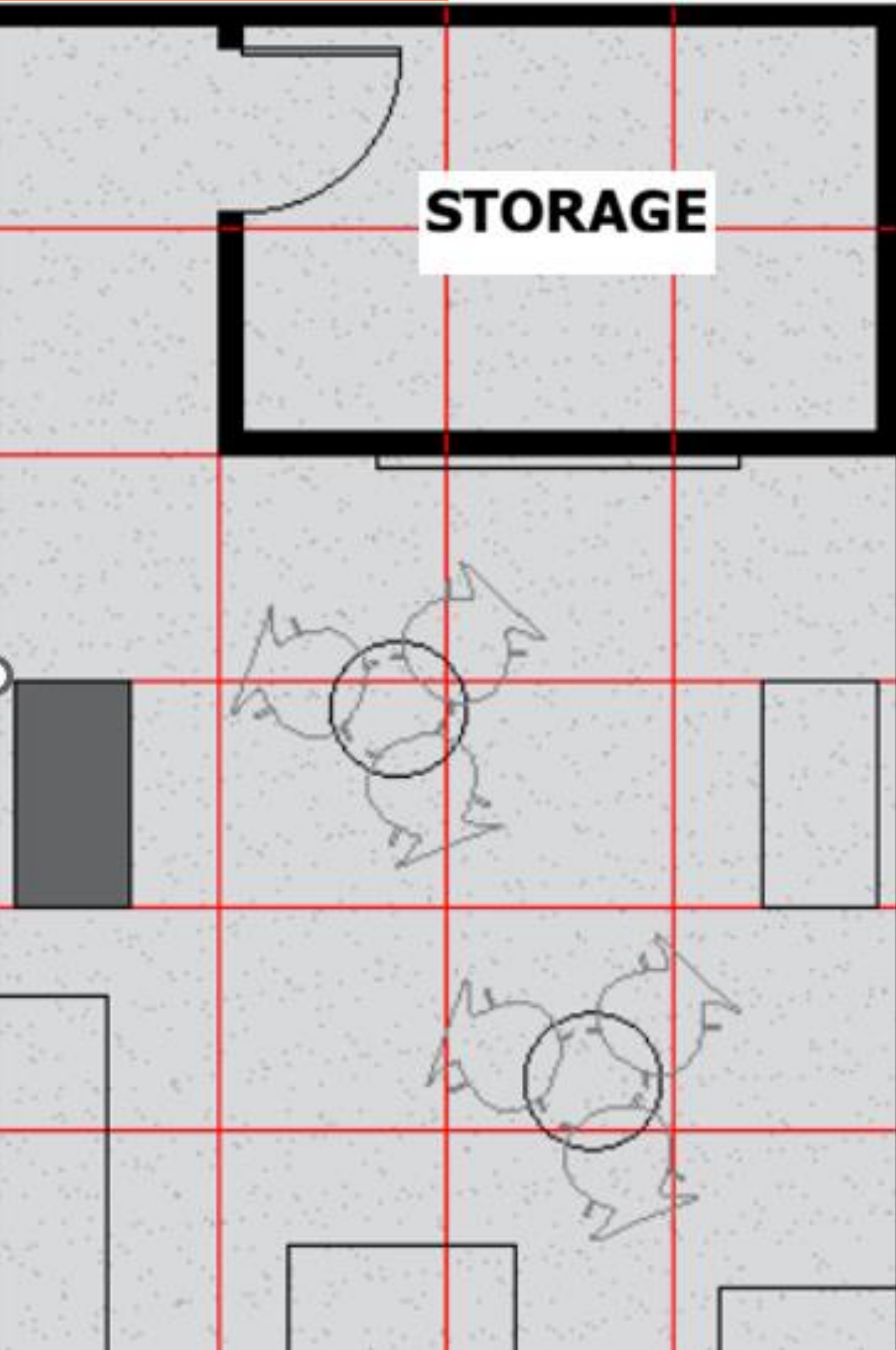

PROJECT SPECIFICATIONS

1.0 – FLOOR

Grey carpet covering applied directly to the pavilion floor.

2.0 – STRUCTURE

The walls will be built in plywood, finished with matte black synthetic leather, according to the project design. Highlight on the main lounge/reception wall, covered with an artificial vegetation panel (vertical garden) in moss green, mounted on a wooden structure. Side structure in metalwork and carpentry, finished in white, with cut-out geometric shapes. Logos will be applied as specified in item 11.0.

3.0 – FRONT SIGNAGE FACADE

The main overhead structure will be built in carpentry, in black and white, forming a portal with a cut-out logo. The main facade will feature a white reception counter/totem with the logo.

4.0 – HEIGHT

External and overhead area: approx. 3.50m

Internal ceiling height: approx. 3.00m

5.0 – CEILING

The ceiling will be built in carpentry, in black and white, in a portal shape, with built-in lighting and suspended niches in black, featuring gardening elements.

6.0 – ELECTRICAL

All power supply and distribution will be carried out using PP cables, with circuits controlled by circuit breakers located in the distribution panel. Installation of built-in LED spotlights and adjustable-focus luminaires throughout the area. Vertical LED strip on the vertical garden panel. Electrical outlets at strategic points (storage, reception counter, and furniture areas).

PROJECT SPECIFICATIONS

7.0 – AREAS

Reception/Lounge Area (Bar/Bistro)

Storage (As per floor plan, with door)

8.0 – AUDIOVISUAL

One LED TV, 42" to 50" (Mounted on the vertical garden panel).

9.0 – LANDSCAPING

Vertical garden on the main wall (artificial vegetation).

Suspended niches in black with plants (ferns) and foliage.

10.0 – FURNITURE – Summary

10.1 – Rental:

- 02 round bistro tables, white or black
- 06 stools (modern design), white

10.2 – Carpentry:

01 Main Reception Counter built in wood, in white, with RX Solutions logo application.

Suspended and side structures built in wood, in black and white, with emphasis on black planters and the white cut-out panel.

01 Internal cabinet in the storage area (if requested).

11.0 – VISUAL COMMUNICATION

- 01 Logo on Overhead Structure
- 01 Logo on Reception Counter
- 01 Logo on Vertical Garden Wall

Assembly
GOLD CANVAS
or
GOLD LED
LAYOUT



Assembly
GOLD CANVAS
or
GOLD LED
LAYOUT



Assembly
GOLD CANVAS
or
GOLD LED
LAYOUT



Assembly
GOLD CANVAS
or
GOLD LED
LAYOUT



PLAN

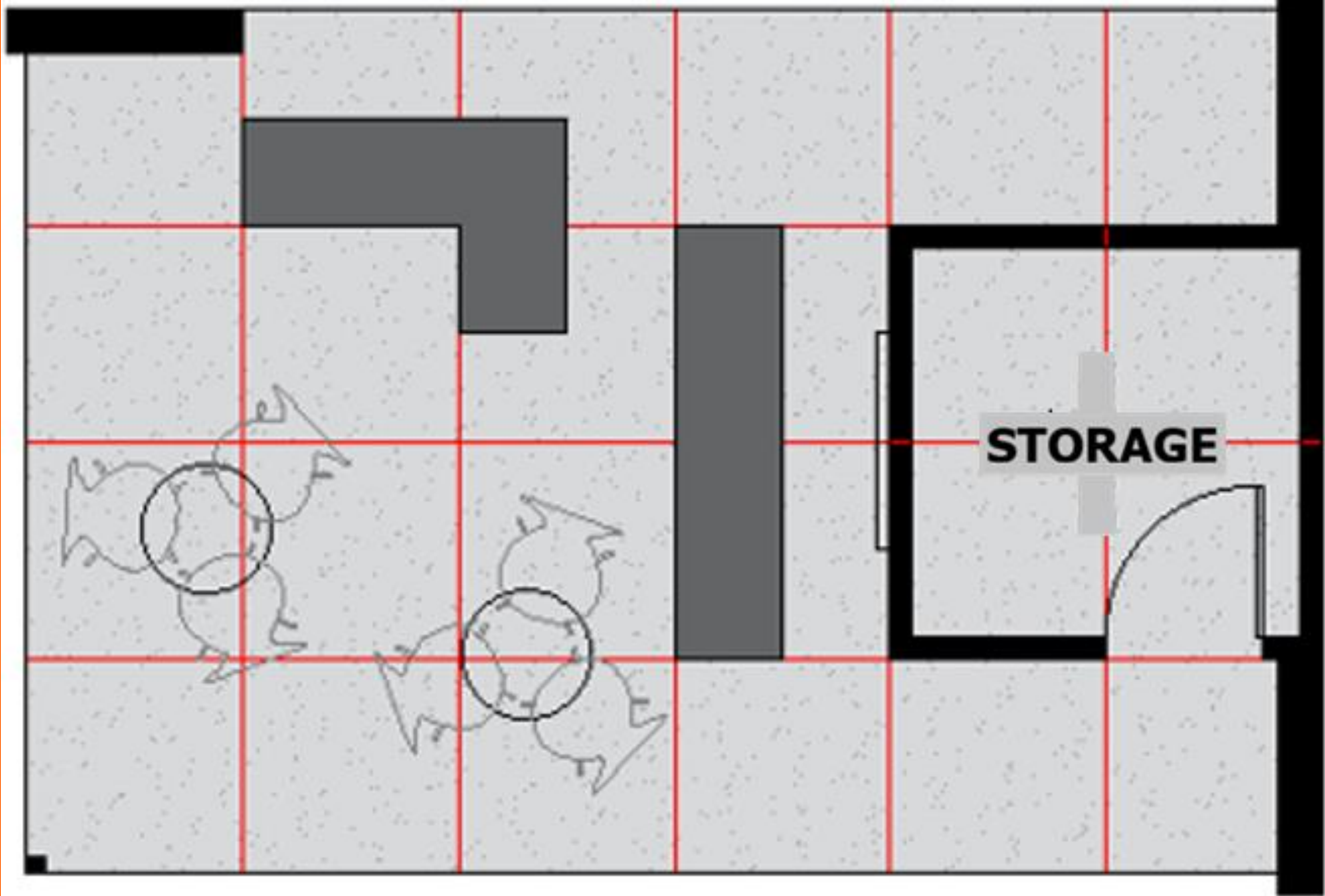

PROJECT SPECIFICATIONS

1.0 – FLOOR

Raised floor at 10 cm with base assembled in iron modules or wooden structure. The covering will be Standard Wood Laminate Flooring (medium/light tone). Finished with corner trim and will include an access ramp according to regulations.

2.0 – STRUCTURE

The walls will be built in plywood with synthetic leather (napa) covering:

Central Panel (Column): Covered in wood-tone synthetic leather (medium/light tone), with built-in lighting details (spotlights) at the top and TV support.

Side Columns: Black metalwork structure.

Front Beam: Built in wood with black synthetic leather covering, including logos.

Storage/Pantry: Built in wood with wood-tone synthetic leather covering.

3.0 – FRONT SIGNAGE FACADE

3.1 – Front Beam:

Will be built in wood with black synthetic leather finish, with logo applications.

3.2 – Façade; IMPORTANT:

- **Gold Canvas Option:** The facade will consist of side columns in black metalwork and visual communication, as detailed in item 2.0.

- **Gold LED Option:** The facade will consist of side columns in black metalwork, an internal LED panel, and black canvas on the external part, as detailed in item 2.0.

4.0 – HEIGHT

Total Structure Height: approx. 4.00m

Clear Ceiling Height: approx. 3.00m

5.0 – CEILING

A false ceiling will be built in plywood, covered in white synthetic leather, with built-in internal LED strip lighting, following the design of the front beam.

6.0 – ELECTRICAL

All power supply and distribution will be carried out using PP cables, with circuits controlled by circuit breakers located in the distribution panel. Includes installation of spotlights, LED strips, and outlets throughout the booth (counter, storage, and lounge area).

PROJECT SPECIFICATIONS

7.0 – AREAS

Reception/Service Area.

Media/Demonstration Point.

Lounge/Social Area with bistro tables.

Pantry/Storage (As per floor plan).

8.0 – AUDIOVISUAL

One TV (approx. 50 inches) mounted on the central panel.

9.0 – LANDSCAPING

Four plant pots suspended by steel cables, fixed to the ceiling structure (type and size of plant to be defined, either artificial or natural with easy maintenance).

10.0 – FURNITURE – Summary

10.1 – Rental:

- **02 bistro tables with round white tops and black bases**
- **06 high stools (modern design), neutral-colored seats (beige)**
- **01 small refrigerator or minibar (in the storage area)**
- **01 stainless steel trash bin, 13 liters (in the storage area)**

10.2 – Carpentry:

01 Reception Counter in “L” shape, built in wood, finished with wood laminate and white top. Includes internal niches.

01 Sideboard/Low Counter under the TV, built in wood with wood laminate finish and black top, with drawers or doors.

01 Support Counter for pantry in the storage area.

11.0 – VISUAL COMMUNICATION

- **03 Logos on Front Beam/Suspended Ceiling**
- **04 Logos on Side Walls**
- **01 Logo on Central Wood Panel**

RX Solutions

Customized Stand **PROPOSAL**

**NEED SOMETHING DIFFERENT?
WE CAN HELP YOU**



Custom Booth **PROPOSAL**

If none of the models shown is right for you,
we can customize one.

HOW?

Just fill out a complete briefing
with everything you will need,
including services.

NEXT STEPS

We'll take care of the entire quote
for you, through a completely
personalized proposal

PERSONALIZED QUOTE SENT WITHIN 10 DAYS

Deadline for project finalization: 30 days prior to the start of assembly,
Over 62 sqm

RX Solutions

Catalog of
SERVICES



Catalog of **SERVICES**



SECURITY

Security is contracted as from the last day of booth assembly and for the days when the event is held, during the time when the show is closed.



CLEANING

The cleaning professional is allocated to the stand during the entire time the event is being held;



RECEPTION

We have optional monolingual (Portuguese), bilingual (English or Spanish) or Trilingual (English and Spanish).

If another language is required, please indicate this when completing the form.



RX
SOLUTIONS
Thank you!